

MilneLibrary

REF
**REFERENCE
COLLECTION**
* IN LIBRARY USE ONLY

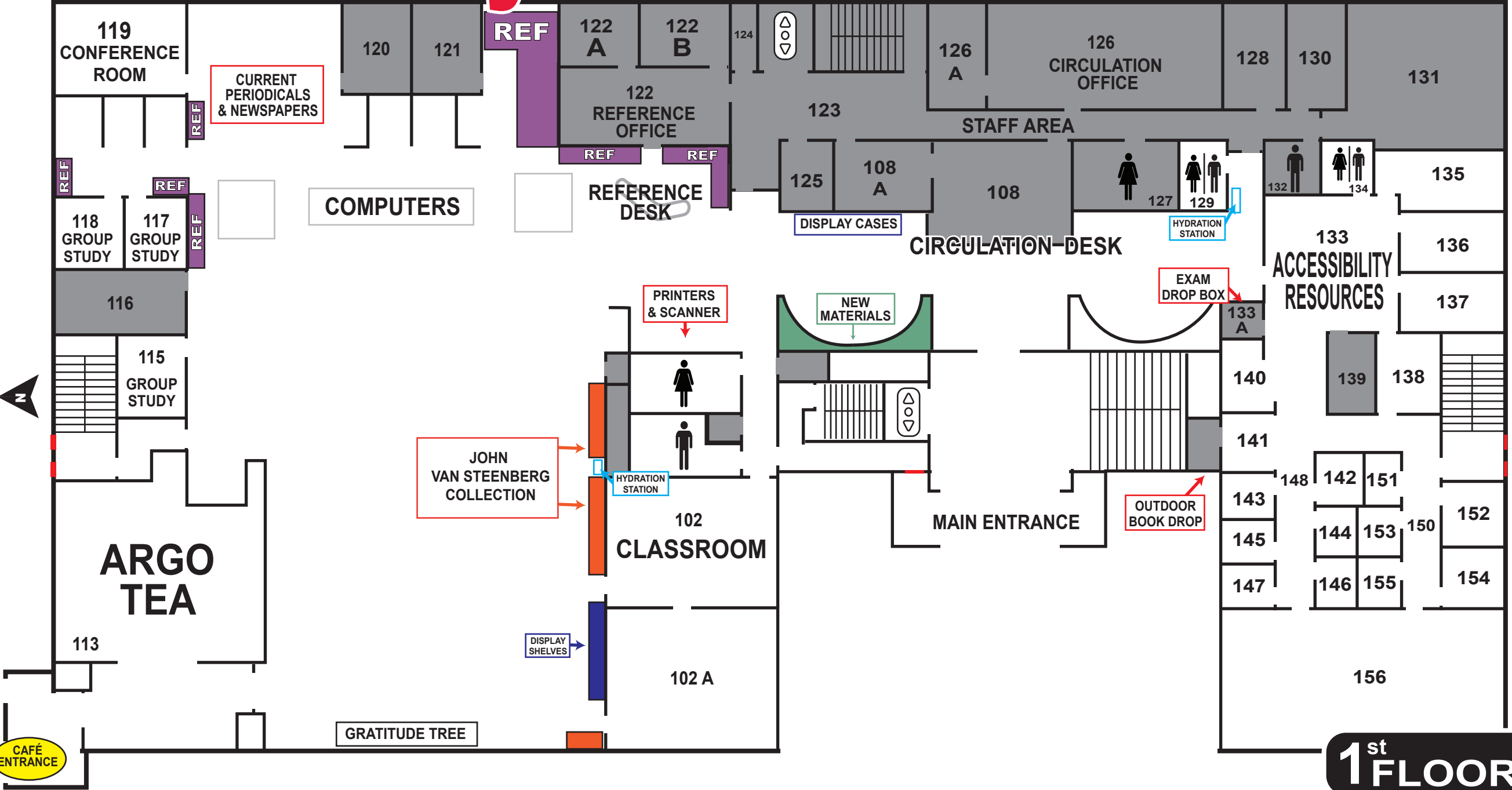

**1st
FLOOR**

M MUSIC

N FINE ART

P LANGUAGE & LITERATURE

MilneLibrary

Dewey Collection

CHILD COLL.

EASY

FIC

YA

GRAPHIC NOVELS & MANGA

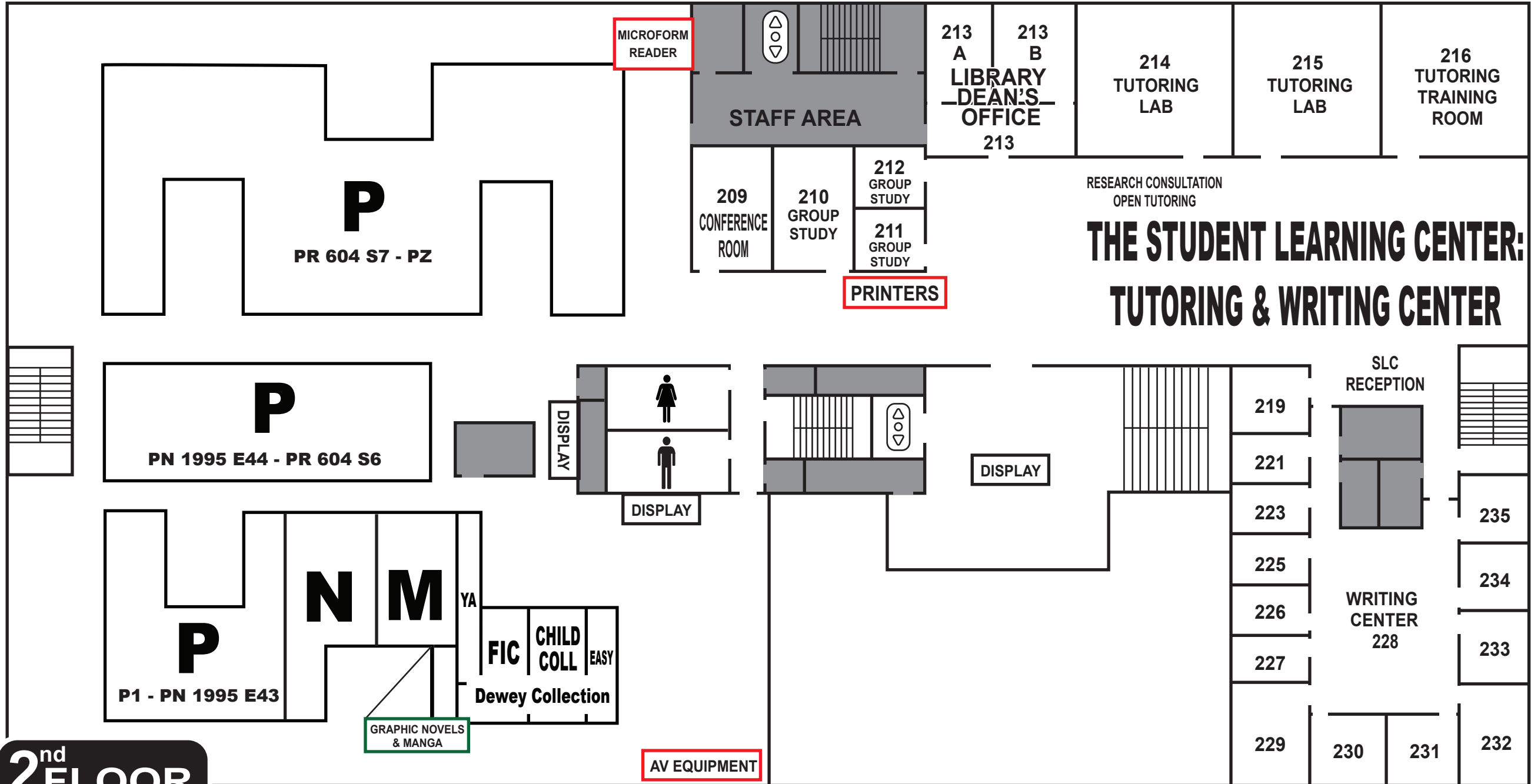

2nd FLOOR

A GENERAL WORKS **B** ● PHILOSOPHY ● PSYCHOLOGY ● RELIGION **C** AUXILIARY SCIENCES OF HISTORY **D** WORLD HISTORY **E** **F** AMERICAN HISTORY

G ● GEOGRAPHY ● ANTHROPOLOGY ● RECREATION **H** SOCIAL SCIENCES **J** POLITICAL SCIENCE **K** LAW **L** EDUCATION

MilneLibrary

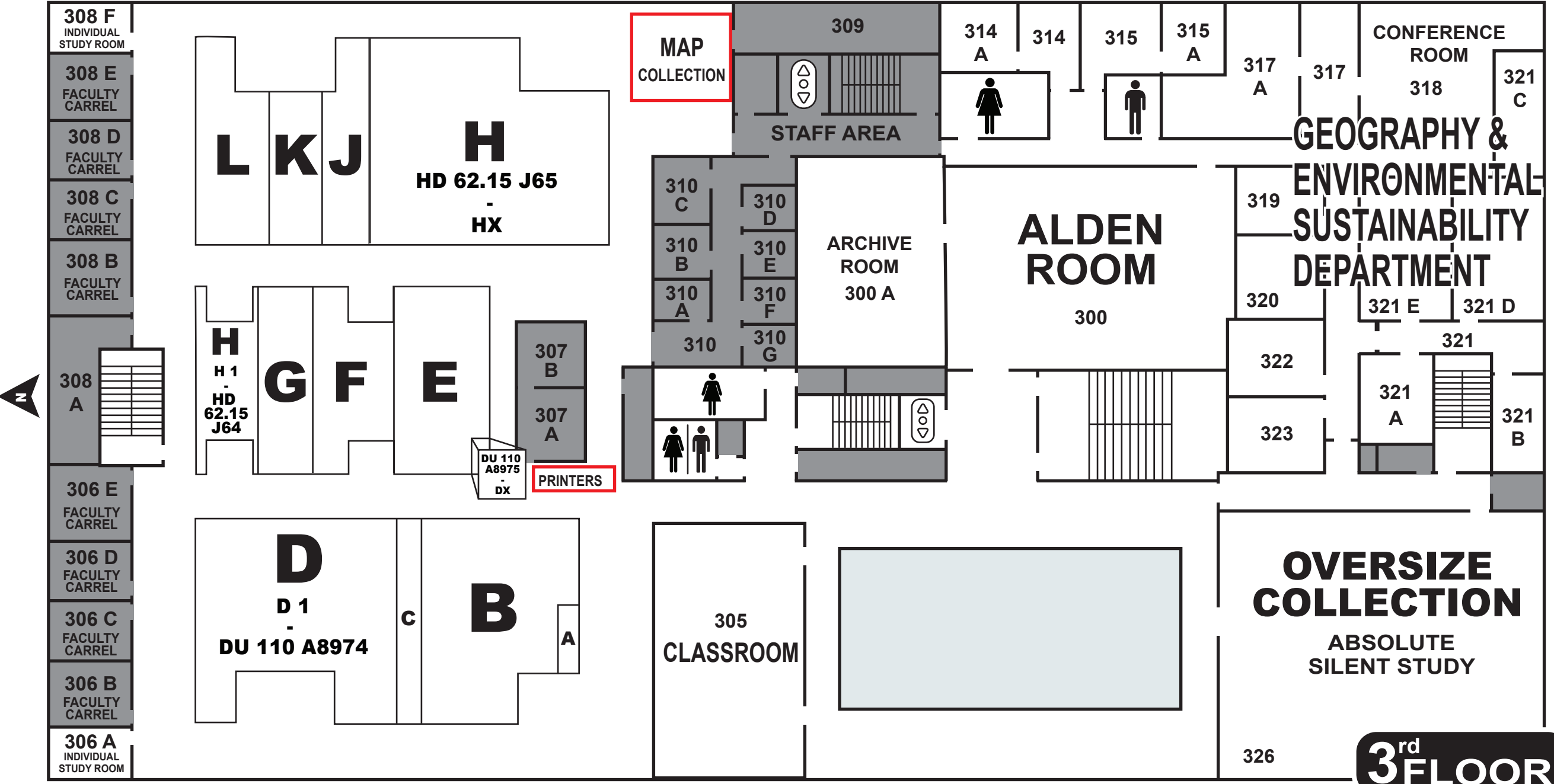

MilneLibrary

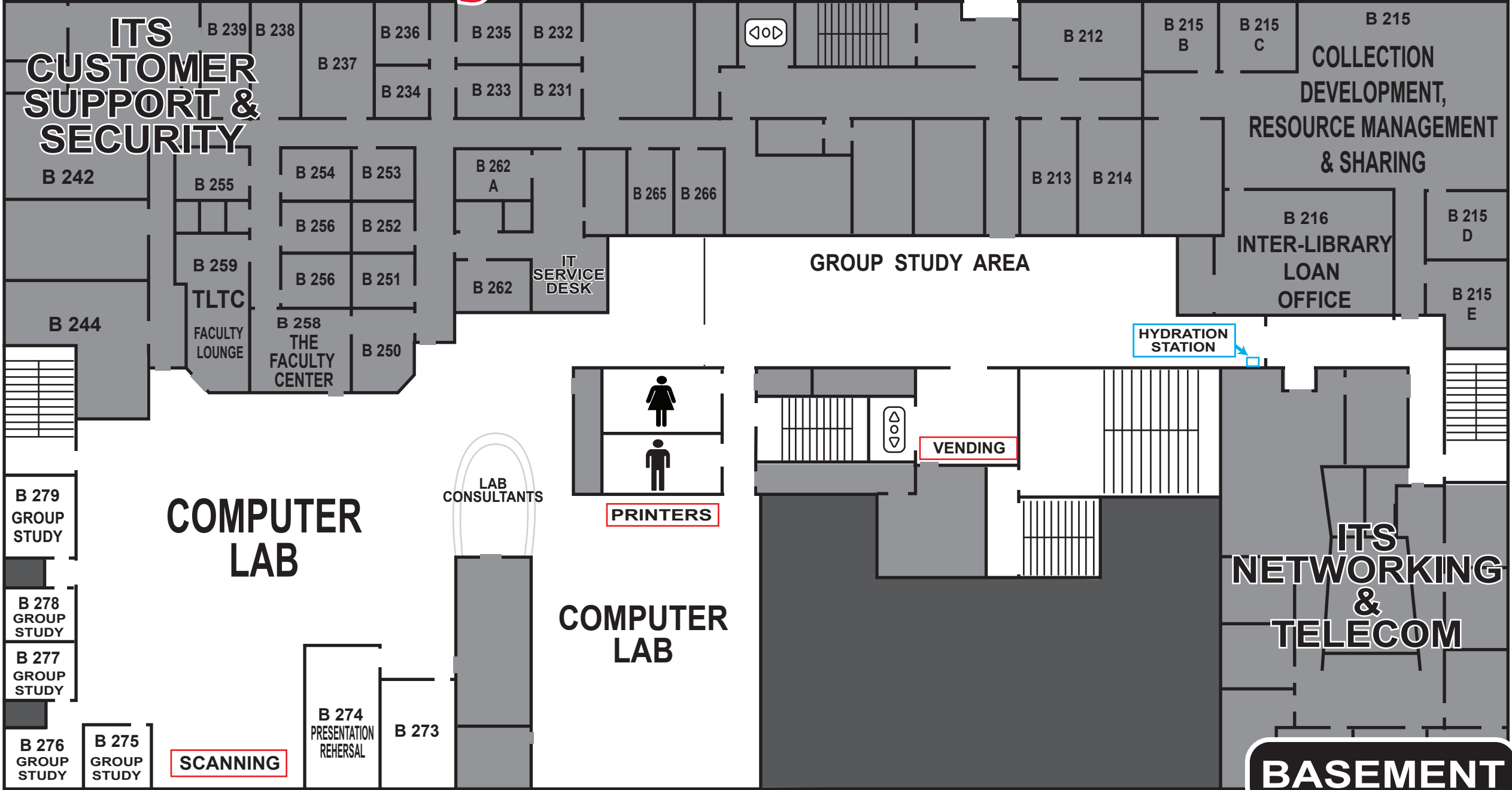

WHERE IS IT? SUB BASEMENT

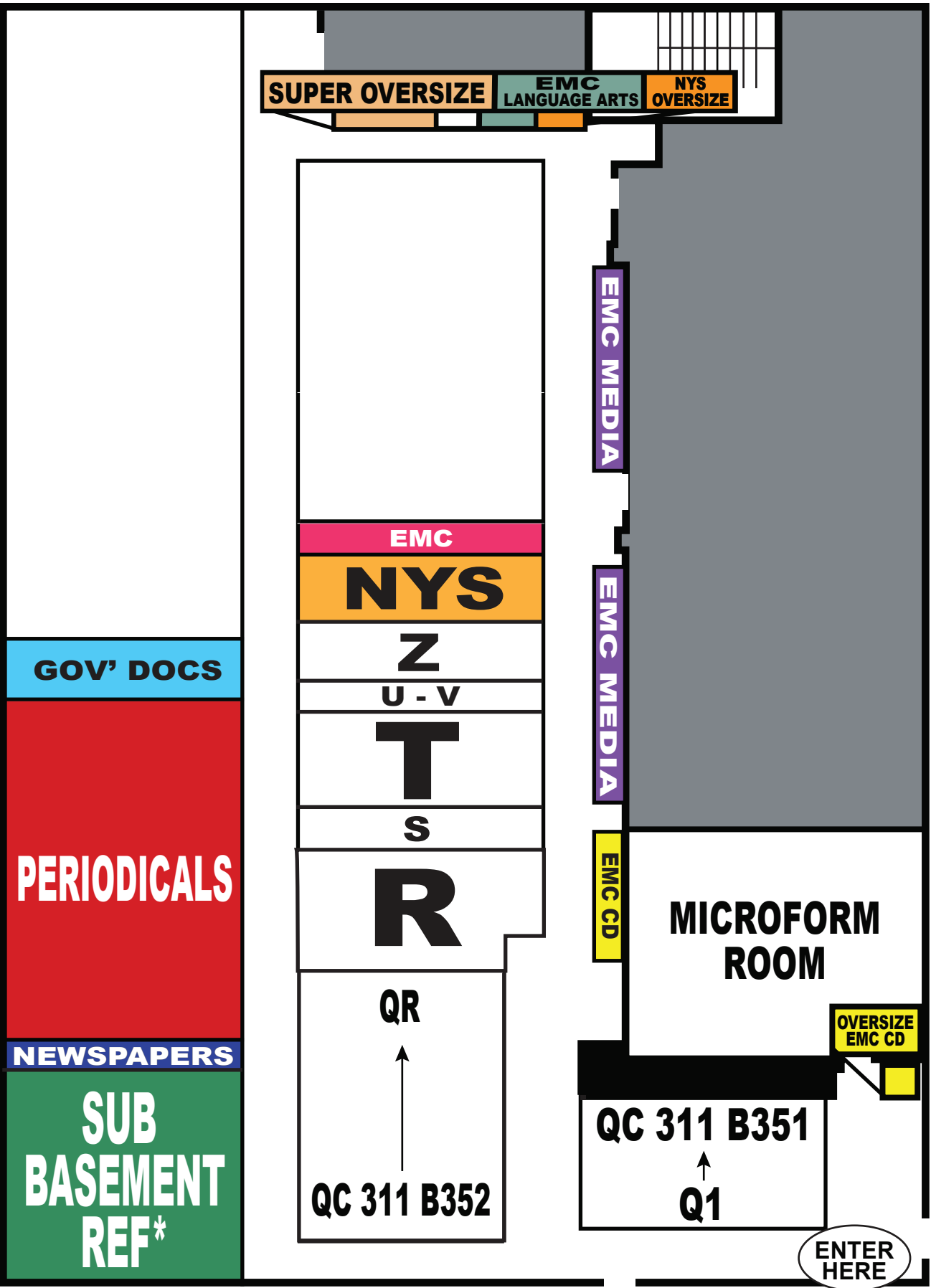

- ## Circulating Collection
- Q**
SCIENCE
 - R**
MEDICINE
 - S**
AGRICULTURE
 - T**
TECHNOLOGY
 - U**
MILITARY SCIENCE
 - V**
NAVAL SCIENCE
 - Z**
• BIBLIOGRAPHY
• LIBRARY SCIENCE
• INFORMATION RESOURCES

EMC	EMC CD	NYS NEW YORK STATE COLLECTION	SUB BASEMENT REF* REFERENCE COLLECTION <small>* IN LIBRARY USE ONLY</small>	PERIODICALS	NEWSPAPERS	US & NYS GOV' DOCS
EMC MEDIA						